

INSTALLATION

Water is to be connected as per diagram below.

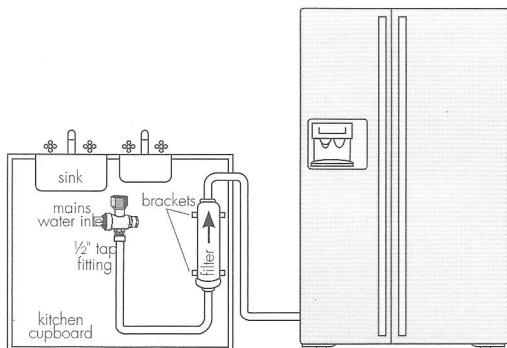

STEP 1

Ensure that the Ice Maker is switched OFF.

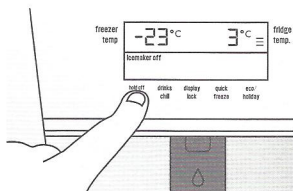

STEP 2

Disconnect refrigerator from power supply.

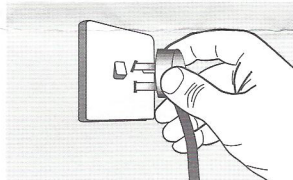

STEP 3

Ensure that the black O-ring inside the 1/2 inch tap fitting on the pressure reducing valve is present and seated. Connect pressure reducing valve to supply tap. Tap must be close to refrigerator.

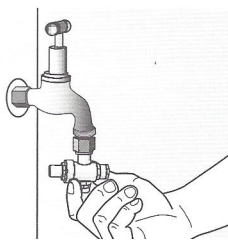

STEP 4

Install the brackets within 1 metre from the water supply tap, in a vertical orientation where possible, using the screws provided.



WARNING

Do not screw the brackets into the refrigerator as this may void your warranty and permanently damage the refrigerator.

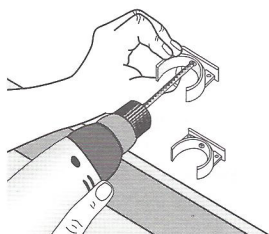

STEP 5

Write date on filter. The filter will need to be replaced every 12 months.

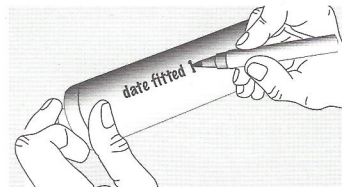

STEP 6

Extend the red collar and clip a circlip around the collar at both ends of the filter.



STEP 7

Fit filter to brackets with water flow arrow pointing up.

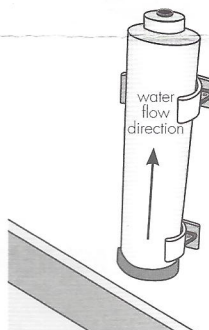

STEP 8

Push shorter tube into pressure reducing valve past insertion mark.

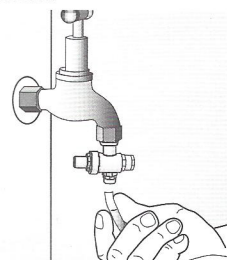

STEP 9

Push other end into filter INLET.



STEP 10

Connect remaining tube length to filter OUTLET.

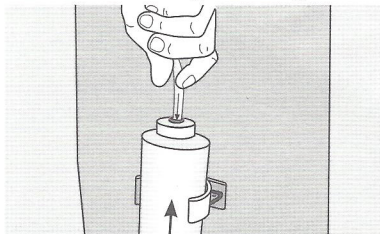

STEP 11

Connect other end of remaining tube length to inlet on bottom right hand side of refrigerator back.

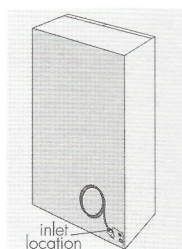
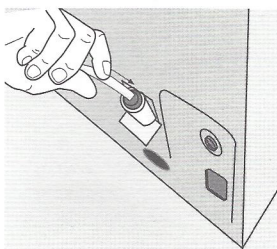

STEP 12

Turn on water and check all joints and tubes for leaks.

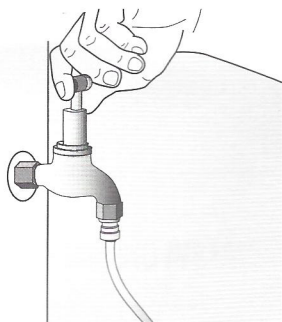

STEP 13

Reconnect the power.

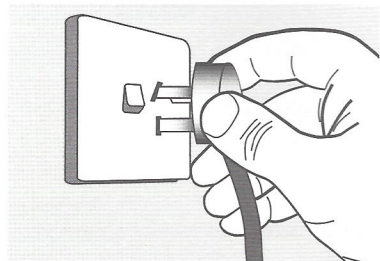

STEP 14

Move the refrigerator back into place being careful not to kink or split the tubing.

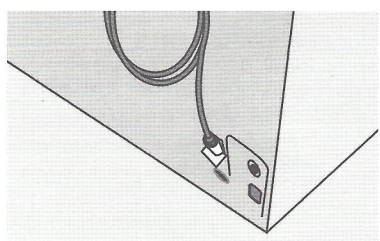

STEP 15

Using a large container run the water dispenser to clear air from lines. This may take a few minutes. Purge and dispense a minimum of 2 litres of water. Initial water may be black in colour. This is residual carbon dust from the filter and is non-toxic. If the water is slow to shut off or the dispenser is dripping, air may still be in the lines. Either purge more water through the system to remove this air or allow some time for the air to be removed over subsequent dispensing.

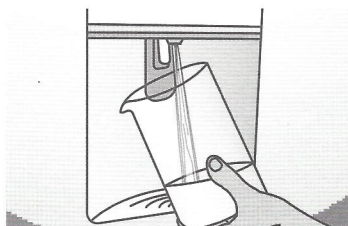

STEP 16

Switch ON Ice Maker.

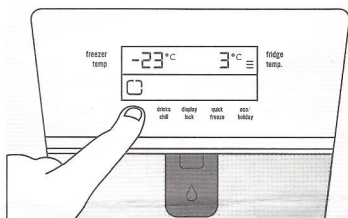

STEP 17

After 24 hours remove ice bin and dispose of first few batches of ice to ensure that impurities have been flushed from the system.

