



Inserting the ice cube container

- Push the ice cube container all the way back onto the supports until it locks into position.



- If the container cannot be pushed all the way back, twist the screw conveyor in the container.

Ice cube production continues.

Disconnecting the ice cube maker

If ice cubes are not to be dispensed for longer than 1 week (e.g. holiday), temporarily disconnect the ice cube maker to prevent the ice cubes from freezing together.



- Press the **Ice Maker Lock** button. The symbol lights up.
- Remove the ice cube container, empty and re-insert. Ensure that the ice cube container engages with the support.

Switching on the ice cube maker again:

- Press the **Ice Maker Lock** button. The symbol goes out.

Water filter

⚠ WARNING ⚠

To avoid serious illness or death, do not use water that is microbiological or chemical unsafe or of unknown quality without adequate disinfection or other treatment before or after use of filter.

Exchanging the filter

⚠ WARNING ⚠

To avoid electrical shock which can cause severe personal injury or death, disconnect power to appliance before changing the filter. After changing, reconnect power.

⚠ WARNING ⚠

- After installing a new water filter always discard the ice production of the first 24 hours after switching on the icemaker.
- If ice has not been used for a prolonged time, discard all ice cubes in the bin and discard the ice production of the next 24 hours.
- If appliance or ice was not actively used for several weeks or months or ice cubes have an unpleasant taste or odor, change water filter.
- Air trapped in system may cause water and cartridge to eject. Use caution when removing.
- The filter should be changed at least every 6 months.

A new filter is available from customer service.

- Disconnect the water supply to the appliance.

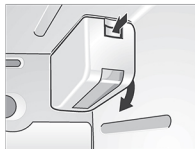

- Push the button and remove the cover from the water filter compartment.

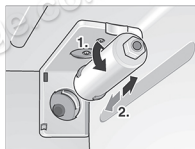

- Rotate the filter cartridge by 90° gently in an anti-clockwise direction (1.) and remove the cartridge.

Take a new filter cartridge out of the packaging and remove the protective cap.

- Insert the new filter cartridge in the holder and rotate the filter cartridge by 90° gently in clockwise direction.

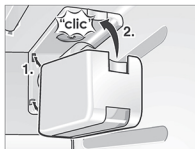

- Insert the cover of the water filter compartment.